

MODEL 579 SVS

APPROX. 2077.33 SQ. FT.
4 BEDROOMS, 2 BATHS

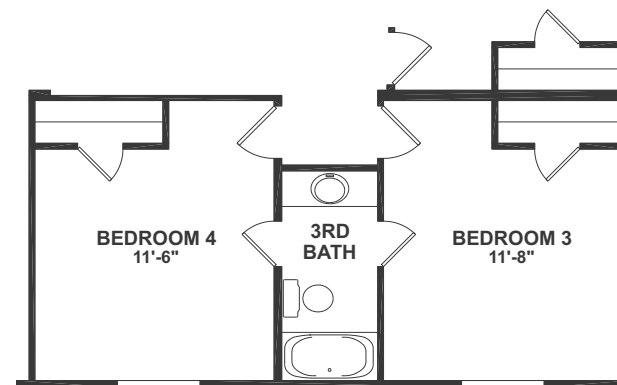
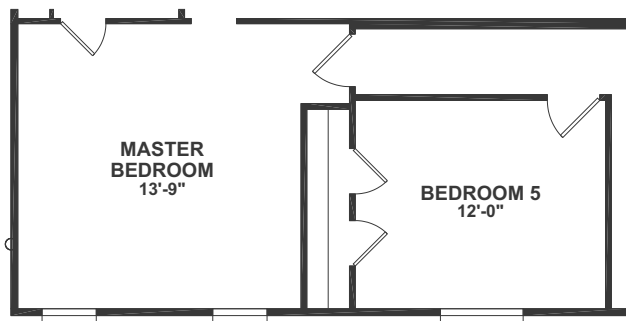

Multi-Section Standard Features

EXTERIOR and STRUCTURE

SMART-PANEL HARDBOARD SIDING BY LOUISIANA-PACIFIC
COMPOSITION ROOF SHINGLES
99 1/2" SPREAD I-BEAMS

STANDARD WALL SUPPORT OUTRIGGERS

2x6 FLOOR JOISTS - 16" ON CENTER (2x8 ON 36 WIDES)

6" END WALL AND SIDE WALL, 16" ON CENTER CONSTRUCTION

6" FULLY VENTED EAVES

PORCH LIGHTS AT ALL EXTERIOR DOORS

EXTERIOR ELECTRICAL OUTLET W/ GFCI PROTECTION

KINRO MADE OVER SIZED WINDOWS

TOP QUALITY, SHELF BOUGHT, EXTERIOR PAINT, BY SHERWIN-WILLIAMS
VINYL SHUTTERS ON FRONT DOOR SIDE WINDOWS AND HITCH END
DETACHABLE HITCHES

LARGE ROOF DORMER (OPTIONAL ON LS AND VALUE SERIES)

ENERGY SAVING and STRUCTURE

NUMBER 2 GRADE LUMBER IN THE FLOOR SYSTEM

R11 WALL AND R11 FLOOR INSULATION BY JOHNS/MANVILLE

R22 ROOF INSULATION (BLOWN)

5 WIRE THERMOSTAT READY BY INTERTHERM

TOTAL ELECTRIC W/ 200 AMP SERVICE (OPTIONAL ON LS AND VALUE SERIES)

ELECTRIC WATER HEATER

30" ELECTRIC RANGE (OPTIONAL ON LS AND VALUE SERIES)

200 AMP ELECTRICAL PANEL BOX (OPTIONAL ON LS AND VALUE SERIES)

POWER RANGE HOOD

PEX PLUMBING SYSTEM W/ BRASS FITTINGS

BRASS SHUT OFF VALVES THROUGHOUT

COPPER GAUGE WIRING THROUGHOUT

POWER VENT FANS IN ALL BATHS

PLUMB AND WIRE FOR WASHER AND DRYER

FURNACE & WATER HEATER MADE BY INTERTHERM

A/C DISCONNECT BOX

GFCI OUTLETS IN ALL WET AREAS

STEEL FRONT DOOR W/ DEAD BOLT (OPTIONAL ON LS AND VALUE SERIES)

COTTAGE REAR DOOR W/ DEAD BOLT (OPTIONAL ON LS AND VALUE SERIES)

MASTER BATH

LUXURY BATH (OPTIONAL OR NOT OFFERED ON LS AND VALUE SERIES)

TRIMMED MIRRORS ABOVE LAVAYS

BRUSHED NICKEL LIGHT FIXTURES ABOVE LAVAYS

PORCELAIN COMMODE

TUB SURROUND: VINYL DECOR

DOUBLE KNOB 4" SET FAUCETS WITH STEM

BEDROOMS and MISCELLANEOUS

BRUSHED NICKEL HARDWARE ON ALL DOORS

BRUSHED NICKEL FLOOR MOUNTED DOOR STOPS

WHITE VINYL COVERED WIRE SHELVING IN ALL BEDROOM CLOSETS

GLASS OVERHEAD LIGHTS IN ALL BEDROOMS

CHAIR RAIL: LR. AND DR. (OPTIONAL ON VALUE SERIES)

WRAPPED FINISHED MOLDINGS THROUGHOUT

FULL DRAPES WITH MINI-BUNDS IN THE LIVING ROOM

MINI-BUNDS WITH VALANCES IN ALL OTHER BEDROOMS

INTERIOR WHITE PASSAGE DOORS

WHITE LINED OVER HEAD CABINETS (OPTIONAL ON LS AND VALUE SERIES)

LAUNDRY OVERHEAD SHELF (OPTIONAL ON LS AND VALUE SERIES)

TUB SURROUND SECONDARY BATHS (OPTIONAL ON LS AND VALUE SERIES)

KITCHEN

18 CU. FT. GE FROST FREE REFRIGERATOR

STAINLESS STEEL DOUBLE BOWL SINK

DOUBLE KNOB FAUCET WITH STEM

HIGH PRESSURE LAMINATE COUNTER TOPS & EDGES

CRYSTAL OAK CABINET MATERIAL

30" KITCHEN OVERHEAD CABINETS

CENTER SHELVES: BASE AND OVERHEADS (BASE OPTIONAL ON VALUE SERIES)

BRUSHED NICKEL HARDWARE ON ALL CABINETS

REFRIGERATOR OVERHEAD SHELF

G.E. APPLIANCES

CERAMIC TILE B/S BEHIND COUNTERS/RANGE (OPTIONAL ON LS AND VALUE SERIES)

DISHWASHER INSTALLED - (OPTIONAL ON LS AND VALUE SERIES)

FLOORS, WALLS, and CEILINGS

VINYL COVERED GYPSUM INTERIOR WALLS T/O

VAULTED CEILINGS THROUGHOUT

SPRAYED ACOUSTICAL CEILINGS

EASY-CARE NO WAX LINOLEUM

19/32" TONGUE AND GROOVED O.S.B. FLOORING

7/16" QUALITY O.S.B. ROOF DECKING

3/8" REBOUND PAD

CARPET BY SHAW INDUSTRIES

For a full list of Standard Features, Please Consult your Oak Creek Professional.
Oak Creek Homes has a continuous product development and improvement process and specifications are subject to change without notice.

7 Year Warranty Coverage

**No surprises.
No big repair bills.**

MORE THAN 40 COMPONENTS OF YOUR HOME ARE PROTECTED FOR SEVEN YEARS BY OAK CREEK HOME GUARD. SERVICE IS QUICK, COMPLETE AND VIRTUALLY HASSLE-FREE.

“WHEN YOU BUILD A HOME AS WELL AS WE DO, AND USE BRAND-NAME MATERIALS, APPLIANCES AND FIXTURES AS WE DO, THEN YOU OFFER A WARRANTY THAT LAST 7 YEARS AND COVERS MOST PARTS OF YOUR HOME - **AS WE DO.**”

OAK CREEK IS PROUD TO PROVIDE OAK CREEK HOME GUARD ON NEW HOMES SOLD BY PARTICIPATING OAK CREEK HOME CENTERS. JUST ASK FOR COMPLETE DETAILS WHEN YOU VISIT AN OAK CREEK HOME CENTER. IT IS JUST ANOTHER WAY YOU KNOW YOU ARE RECEIVING THE BEST QUALITY HOME WHEN YOU CHOOSE OAK CREEK.

THE EXCLUSIVE OAK CREEK HOME GUARD

OFFERS 7 YEARS OF PROTECTION ON:

<input checked="" type="checkbox"/> STEEL FRAME	<input checked="" type="checkbox"/> CHIMNEY	<input checked="" type="checkbox"/> RECEPTACLES
<input checked="" type="checkbox"/> SUB-FLOOR	<input checked="" type="checkbox"/> CONNECTIONS	<input checked="" type="checkbox"/> BOXES
<input checked="" type="checkbox"/> DOORS	<input checked="" type="checkbox"/> JOINTS	<input checked="" type="checkbox"/> SWITCHES
<input checked="" type="checkbox"/> WINDOWS	<input checked="" type="checkbox"/> A/C UNIT	<input checked="" type="checkbox"/> OUTLETS
<input checked="" type="checkbox"/> FRAMING	<input checked="" type="checkbox"/> COMPRESSOR	<input checked="" type="checkbox"/> LIGHT FIXTURES
<input checked="" type="checkbox"/> WALLS	<input checked="" type="checkbox"/> A-FRAME	<input checked="" type="checkbox"/> WATER LINES
<input checked="" type="checkbox"/> ROOF STRUCTURE	<input checked="" type="checkbox"/> REFRIGERATOR	<input checked="" type="checkbox"/> WATER HEATER
<input checked="" type="checkbox"/> CEILINGS	<input checked="" type="checkbox"/> RANGE/OVEN	<input checked="" type="checkbox"/> WASTE PIPES
<input checked="" type="checkbox"/> EXTERIOR SIDING	<input checked="" type="checkbox"/> DISHWASHER	<input checked="" type="checkbox"/> FAUCETS
<input checked="" type="checkbox"/> FURNACE	<input checked="" type="checkbox"/> MICROWAVE OVEN	<input checked="" type="checkbox"/> TOILETS
<input checked="" type="checkbox"/> BLOWERS	<input checked="" type="checkbox"/> WASHER/DRYER	<input checked="" type="checkbox"/> SINKS
<input checked="" type="checkbox"/> DUCT WORK	<input checked="" type="checkbox"/> DISPOSAL	<input checked="" type="checkbox"/> BATH TUBS
<input checked="" type="checkbox"/> VENT PIPES	<input checked="" type="checkbox"/> WIRING	<input checked="" type="checkbox"/> SHOWER STALLS