

Model 2306

(1918 SQ. FT.)
 3 BEDROOMS, 2 BATHS

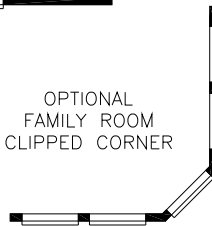

OPTIONAL
 FAMILY ROOM
 CLIPPED CORNER



Classic Multi-Section Standard Features

Appliances and Equipment

- .INTERMEDIATE ELECTRIC UP-FLOW FURNACE
- .TOTAL ELECTRIC
- .GE ELECTRIC RANGE
- .17" FF REFRIGERATOR
- .PLUMB FOR CLOTHES WASHER
- .WIRE/VENT FOR DRYER
- .30 GALLON ELECTRIC WATER HEATER
- .FIBERGLASS HEAT/COOLING DUCTS
- .WATER SHUT-OFF VALVES
- .EXTERIOR FROST FREE FAUCET
- .EXTERIOR GFI RECEPTACLE
- .BEDROOM CEILING LIGHTS
- .WATER HEATER "SAFETY GUARD" DRIP PAN
- .BATHROOM EXHAUST FANS
- .3 ARM DR CHANDELIER
- .8 WIRE THERMOSTAT CABLE
- .A/C DISCONNECT OR 17X17 COOLER VENT
- .FULL HOUSE MASTER WATER SHUTOFF
- .DEDICATED FREEZER RECEPT. (WHERE APPLICABLE)

Exterior Detailing

- .ICI/GLIDDEN LATEX PAINT
- .TRI-COLOR EXTERIOR PAINT
- .ALL WINDOWS ARE TRIMMED
- .ACRYLIC "TILT-IN" ENERGY STAR WINDOWS
- .36" RESIDENTIAL DOOR - FRONT w/ STORM
- .EXTERIOR LIGHTS - ALL DOORS
- .DELUXE GABLE FRONT ELEVATION
- .32" RESIDENTIAL DOOR - REAR w/ STORM
- .DEADBOLTS - EXTERIOR DOORS

Construction Features

- .90" SIDEWALL HEIGHT
- .VAULTED CEILINGS - THROUGHOUT
- .SMART PANEL SIDING
- .COMPOSITION "SHINGLE" ROOF
- .2x6/2x8 #2 FLOOR JOISTS @ 16" OC
- .DETACHABLE HITCH ASSEMBLY
- .ENERGY STAR RATING R-30/11/11 INSULATION
- .LOW E, 6/6 GRID THERMAL WINDOWS
- .OSB FLOOR DECKING
- .12" FULLY VENTED EAVE OVERHANGS
- .TAPE & TEXTURED WALLS/CEILING T/O
- .BULL NOSE CORNERS

Finishing and Trim

- .UPGRADE FRONTIER PLYUSH 16 Oz CARPETING T/O
- .ORANGE PEEL TEXTURE WALLS/CEILINGS
- .FLAT ICI/GLIDDEN PAINT
- .TACK STRIP & RE-BOND PAD
- .150# UPGRADE DOOR HINGES
- .1-3/8" THICK PASSAGE DOORS
- . "NO WAX" FLOOR VINYL; KIT. & UTILITY
- .UTILITY ROOM SHELF
- .FULLY LINED & TRIMMED CLOSETS
- .4" COVE MOLDING - LR, DR, KIT, MBR, MBA, AND HALL
- .PAINTED DOOR JAMBS & CASINGS
- .WHITE EMBOSSED PASSAGE DOORS
- .DELUXE DRAPES LR, DR, AND MBR
- .WHITE PAINTED MOLDING TRIM
- .2" FAUX WOOD MINI-BLINDS ALL EXC. BATHROOMS
- .CERAMIC TILE BACKSPLASH (KITCHENS & BATHS)
- .WOOD FURNACE COMPARTMENT DOOR

Kitchens and Baths

- . "MOEN" FAUCETS ALL BATHS AND KITCHEN
- .SINGLE LEVER KITCHEN FAUCET
- .FULLY LINED OH CABINETS
- .RESIDENTIAL ELONGATED COMMODES
- .RESIDENTIAL COMMODE RISERS
- .CHINA COMMODO TANKS
- . "ANTI-SCALD" TUB/SHOWER FAUCET PROTECTION
- .SOLID RECESSED OAK KIT. CABINET DOORS
- .ADJUSTABLE KITCHEN SHELVES
- .CROWN MOLDING ON KITCHEN OH CABINETS
- . "CLASSIC WHITE" RTF BATHROOM CABINETS
- .SINGLE LEVER SHOWER FAUCET
- .ONE-PIECE EMBOSSED FIBERGLASS SHOWER - MBA
- .ONE-PIECE TUB -MBA
- .DUAL STEEL DRAWER GUIDES
- .KITCHEN SINK TILT-OUT "MINI-BINS"
- .CHINA LAVY SINKS
- .DRAWER BANK - MBA
- .DRAWERS OVER DOORS CABINETS - KITCHEN
- .36"x36" GLASS BLOCK WINDOW(WHERE APPLICABLE)
- .TILEX TUB SURROUNDS HALL BATH (S)
- .CATALINA LIGHTING PACKAGE
- .BEVEL MIRRORS ALL BATHS

For a full list of Standard Features, Please Consult your Oak Creek Professional.
Oak Creek Homes has a continuous product development and improvement process and specifications are subject to change without notice.

7 Year Warranty Coverage

**No surprises.
No big repair bills.**

MORE THAN 40 COMPONENTS OF YOUR HOME ARE PROTECTED FOR SEVEN YEARS BY OAK CREEK HOME GUARD. SERVICE IS QUICK, COMPLETE AND VIRTUALLY HASSLE-FREE.

"WHEN YOU BUILD A HOME AS WELL AS WE DO, AND USE BRAND-NAME MATERIALS, APPLIANCES AND FIXTURES AS WE DO, THEN YOU OFFER A WARRANTY THAT LAST 7 YEARS AND COVERS MOST PARTS OF YOUR HOME - **AS WE DO.**"

OAK CREEK IS PROUD TO PROVIDE OAK CREEK HOME GUARD ON NEW HOMES SOLD BY PARTICIPATING OAK CREEK HOME CENTERS. JUST ASK FOR COMPLETE DETAILS WHEN YOU VISIT AN OAK CREEK HOME CENTER. IT IS JUST ANOTHER WAY YOU KNOW YOU ARE RECEIVING THE BEST QUALITY HOME WHEN YOU CHOOSE OAK CREEK.

THE EXCLUSIVE OAK CREEK HOME GUARD OFFERS 7 YEARS OF PROTECTION ON:

- | | | |
|---|--|--|
| <input checked="" type="checkbox"/> STEEL FRAME | <input checked="" type="checkbox"/> CHIMNEY | <input checked="" type="checkbox"/> RECEPTACLES |
| <input checked="" type="checkbox"/> SUB-FLOOR | <input checked="" type="checkbox"/> CONNECTIONS | <input checked="" type="checkbox"/> BOXES |
| <input checked="" type="checkbox"/> DOORS | <input checked="" type="checkbox"/> JOINTS | <input checked="" type="checkbox"/> SWITCHES |
| <input checked="" type="checkbox"/> WINDOWS | <input checked="" type="checkbox"/> A/C UNIT | <input checked="" type="checkbox"/> OUTLETS |
| <input checked="" type="checkbox"/> FRAMING | <input checked="" type="checkbox"/> COMPRESSOR | <input checked="" type="checkbox"/> LIGHT FIXTURES |
| <input checked="" type="checkbox"/> WALLS | <input checked="" type="checkbox"/> A-FRAME | <input checked="" type="checkbox"/> WATER LINES |
| <input checked="" type="checkbox"/> ROOF STRUCTURE | <input checked="" type="checkbox"/> REFRIGERATOR | <input checked="" type="checkbox"/> WATER HEATER |
| <input checked="" type="checkbox"/> CEILINGS | <input checked="" type="checkbox"/> RANGE/OVEN | <input checked="" type="checkbox"/> WASTE PIPES |
| <input checked="" type="checkbox"/> EXTERIOR SIDING | <input checked="" type="checkbox"/> DISHWASHER | <input checked="" type="checkbox"/> FAUCETS |
| <input checked="" type="checkbox"/> FURNACE | <input checked="" type="checkbox"/> MICROWAVE OVEN | <input checked="" type="checkbox"/> TOILETS |
| <input checked="" type="checkbox"/> BLOWERS | <input checked="" type="checkbox"/> WASHER/DRYER | <input checked="" type="checkbox"/> SINKS |
| <input checked="" type="checkbox"/> DUCT WORK | <input checked="" type="checkbox"/> DISPOSAL | <input checked="" type="checkbox"/> BATH TUBS |
| <input checked="" type="checkbox"/> VENT PIPES | <input checked="" type="checkbox"/> WIRING | <input checked="" type="checkbox"/> SHOWER STALLS |